

Copper Press Coupler (M-Profile)

MCP 01



Features & Benefits

- Durable and secure leak proof joint
- Braze free, permanent joint - no hot works required
- Huge time and resource savings
- 25 Year warranty
- Blue plastic film which will fall off when crimped for easy identification of pressed joint
- 2 point press
- Dust Covers

Material Specifications

NO	Description	Materials
1	Body	Cu-DHP (CW024A)
2	Crimp indicator film	PVC, Blue
3	O-Ring	EPDM
4	Dust Cap	PE

Technical Data

- Working Pressure 16 Bar @ 95°C
- "M" profile press jaws or slings
- Approved tools include Novapress, REMS, Rothenberger and Ridgid

Applicable Standards

- WRAS approved
- For use with type TX copper tubing conformant to EN 1057
- Manufactured to EN1254 standard

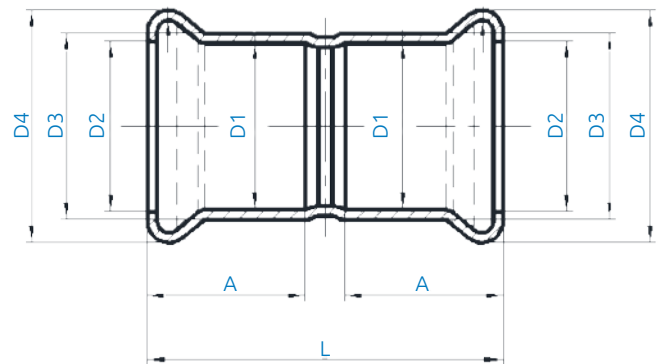

Product Codes and Dimensions

STOCK NO.	D1	D2	D3	D4	A	L
27940	15	15.6	18	23	19	44
27941	22	22.8	25	31.3	20	46
27942	28	28.8	31	37.4	22	50
27943	35	35.7	38.3	44.7	25	58
27944	42	42.8	45.3	53.5	29	67
27945	54	54.8	57.3	65.3	34	80
27946	67	69.1	71.7	82.6	48	107
27947	76	78.6	81.1	94.4	49	108
27949	108	110.9	113.8	132.1	65	147