

# ➤ Bronze Double Check Valve - Compression NRV2C



## Features and Benefits

- Double check valves when fitted stop the flow of water in one direction preventing back flow.
- Bronze body with compression ends for copper pipework systems.

## Applicable Standards

- Compression connections comply with EN1254-2

## Technical Data

- Fields of applications: water
- Max working pressure: PN16
- Operating temperature range: -5°C to +60°C

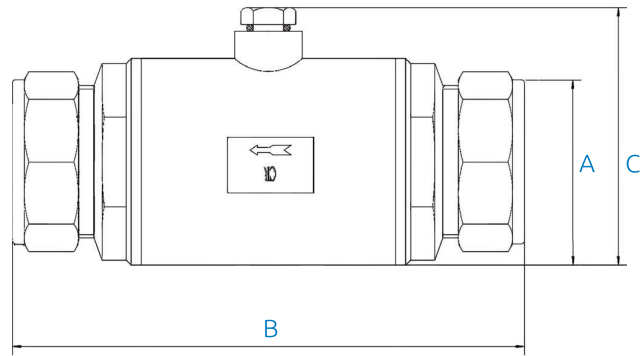

## Product Codes & Dimensions

STOCK NO	A	B	C
30711	35	149	74.5
30712	42	165	83
30713	54	175	97

## Material Specifications

ITEM	PARTS	MATERIAL	QTY
1	Brass	C83600	1
2	Filter	ABS Plastic	1
3	Seals	NBR rubber	2